

NEW

SAF SBS 2220 K0

SERIES LAUNCH OF THE NEW TRAILER DISC BRAKE SAF SBS 2220 K0 FROM OCTOBER 2015

SAF-HOLLAND is to launch the new 22.5" disc brake
SAF SBS 2220 K0 for the 9 t axle range.

The new SAF disc brake SBS 2220 K0 is available from
the 4th Quarter of 2015 as an alternative to the proven
SAF disc brake SBS 2220 H0, and is to replace axle version
xx9-22K01 in the mid-term.

For special applications and higher tonnages, the axle
models ending in -22K01 (e.g. SI/Z11-22K01) will continue
to be available.

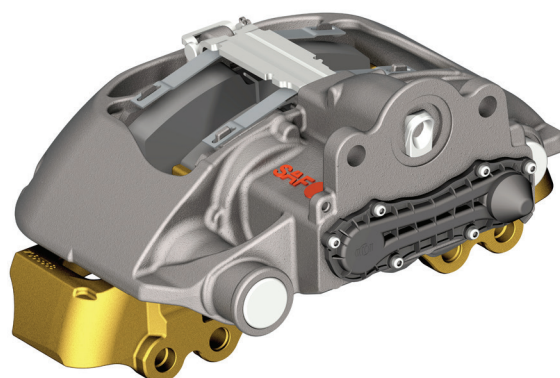

New axle models	Existing axle model	
RIGID AXLES		
BI9 - 22S01	BI9 - 22S	BI9 - 22K01
BI9 - 22S01	B9 - 22S	B9 - 22K01
SI9 - 22S01	SI9 - 22S	SI9 - 22K01
ZI9 - 22S01	ZI9 - 22S	ZI9 - 22K01
FRICTION-STEERED AXLES FOR INTRA CD AND MODUL		
BIL9 - 22S01	BIL9 - 22S	BIL9 - 22K01
BL9 - 22S01	BL9 - 22S	BL9 - 22K01
FRICTION-STEERED AXLES FOR INTRA		
BILL9 - 22S01	BILL9 - 22S	BILL9 - 22K01
BLL9 - 22S01	BLL9 - 22S	BLL9 - 22K01

OVERVIEW

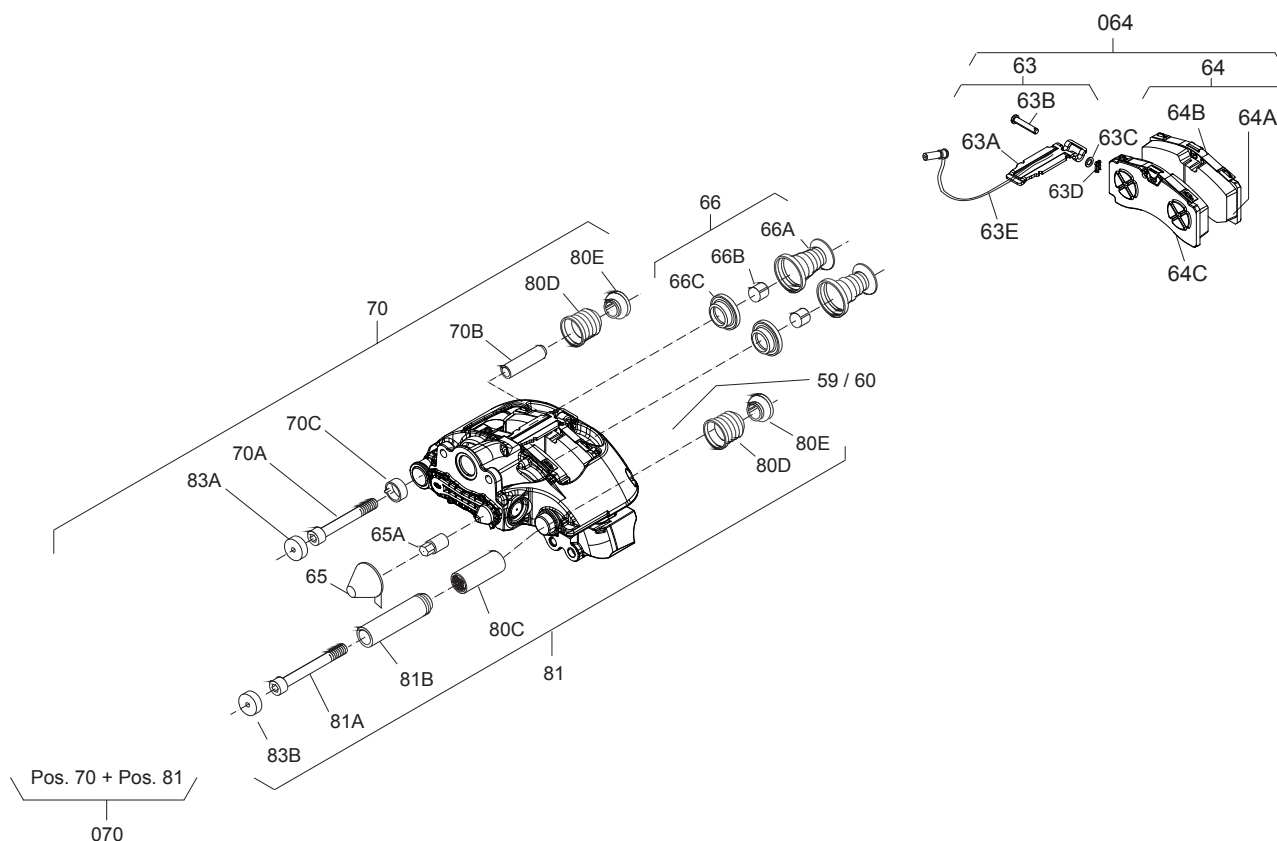

Order no.	Description	Position
03 080 0087 00	Disc brake caliper-Kit - LH	59
03 080 0088 00	Disc brake caliper-Kit - RH	60
03 057 0006 00	Reapir-Kit Pad	064
03 434 3823 00	Repair-Kit	66
03 434 3824 00	Repair-Kit seal	070
03 434 3816 00	Univ. adjuster cap	65

The part lists and exploded views for SAF SBS 2220 K0 are now available on POD „parts on demand“.

SAF-HOLLAND GmbH

Business Unit Aftermarket · Hauptstraße 26 · 63856 Bessenbach · Germany · Tel +49 6095 301-301

www.safholland.com

